

2025 SS AGILE

Live for the Moments

No matter the destination, Roadtrek's SS Agile, built on the Mercedes-Benz Short Sprinter Chassis, can turn every trip into an unforgettable experience. Offering all the conveniences of a larger motorhome, the SS Agile is a fully equipped for comfort while allowing you the maneuverability of a van. The SS Agile won't make you sacrifice your dreams, but instead, help you fulfill them.

Perfect for weekend getaways, full-time RV living, or just as your daily driver; the SS Agile will change your life.

Exterior Paint Options



Grey White



Silver Ice



Selenite Grey



Grey White - built on Mercedes-Benz Sprinter 2500 144" Van w/9spd transmission, 2.0L Turbo Diesel, 4 cyl Diesel, Availale optional AWD.



Your authorized dealer representative



Build your **SS Agile** today at roadtrek.com/build-your-own

SS Agile Specifications

| Capacity | |
|--|---|
| Travel Capacity | 5 |
| Sleeping Capacity | 2 |
| Sleeping Capacity w/ Front Folding Mattress (Optional) | 3 |
| Chassis Year | US 2023 CAD 2024 |
| Advanced Safety | Active Brake Assist, Electric Parking Brake, Active Distance Assist, Active Lane Keeping Assist, Attention Assist, Blind Spot Assist, Electrically Adjustable Swivel Cab Seating, Wet Wiper System, Lumbar Support, Comfort Headrest, Multi-Function Steering Wheel, Electric Heated Folding Exterior Mirrors, Leather Wrap Steering Wheel, Traffic Sign Assist, High Beam Assist, LED Headlights, Fog Lamps with Cornering Function, Power Sliding Door, Parking Package with Backup Camera, Security Alarm, 360° Camera |
| HD Radio | GPS Navigation, 10.25" multi-media display, Android Auto, Apple Car Play, Blu-tooth interface, Satellite radio |
| Cargo Carrying Capacity (CCC) CDN | 943 lbs. (428 kg) |
| Occupant & Cargo Carrying Capacity (OCCC) US | 1500 lbs. (680 kg) |
| Dry Weight | 7496 lbs. (3400 kg) |
| Hitch Weight Rating | 5000 lbs. (2268 kg.) |
| Exterior Length | 19' 5" (5,918 mm) |
| Exterior Width (without mirrors) | 6' 8" (2,032 mm) |
| Exterior Height (with roof A/C) | 9' 7" (2,921 mm) |
| Interior Standing Height | 6' 3" (1,910 mm) |
| Electrical | |
| Coach Control System | Firefly coach control system monitors water, propane, battery charge levels, battery disconnect & generator hour meter |
| Batteries | 600 AMP Lithium |
| Inverter | 3000-Watt Power Inverter |
| Solar | 300 W |
| Holding Tanks | |
| Fresh Water Capacity | 113.5 L/30 U.S. GAL |
| Black Water Capacity | 37.8 L/10 U.S. GAL |
| Gray Water Capacity | 75.7 L/20 U.S. GAL |
| Sewage Disposal System | Dual waste management system includes 12 V macerator sewage pump |
| HVAC | |
| Water System | 40,000 BTU tankless water heater |
| Furnace | Propane automatic, 16,000 BTU |
| A/C | 110 V, 11,000 BTU roof mount |
| Propane | 16 gal. / 60 L LP Tank w/ Exterior Quick Connect |
| Kitchen | |
| Refrigerator | 12 V, 3.1 CU FT. Compressor |
| Microwave | 110 V, 28L/1.0 CU FT., 1800 W convection/1000 W microwave |
| Stove- Propane (Standard) | Two burners recessed with flush cover and built-in igniter |
| Stove- Induction (Optional) | 110V flush mounted one burner Inductive Cooktop |
| Sleeping | |
| Rear Sleeping QUEEN (wxl) | 62"x68" (1575mm x 1727mm) |
| Forward Facing Rear Power Sofa | Forward facing rear power sofa with leatherette upholstery and 3 seat belts. Easily converts to a queen-size bed. |
| Option: Front folding mattress (option) (wxl) | 22"x76" (559mm x 1930mm) |
| Storage | |
| Cabinets/Drawers | 15 |
| Exterior | |
| Interior Windows | 9 |
| Awning | 10' Power Awning |



Daytime Configuration

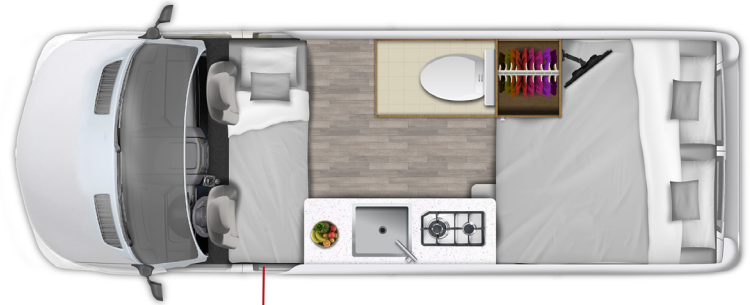

Optional Cab Cushion

Nighttime Queen Configuration

Interior Décor

White Sand

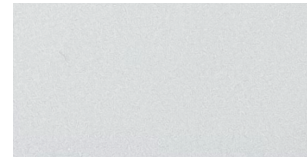

Cabinet Doors



Cabinetry

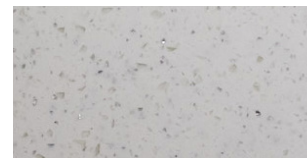

Countertop



Flooring



Italian Leather

Chestnut

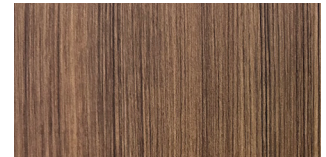

Cabinet Doors



Cabinetry



Countertop



Flooring



Italian Leather



Build your **SS Agile** today at roadtrek.com/build-your-own

Roadtrek Inc. reserves the right to make changes at any time, without notice or obligation to colours, materials, equipment, specifications, standards, options, and models. This information is intended as a guide only. Units may be shown with optional equipment. Photo accessories are not included. Brochure printed in Canada, September 2024.